

# Paddle - Flow Switch



Registered No. 325327

## GENERAL CHARACTERISTICS

The instruments are working according to the technology of a spring and bellow supported paddle. Electrical contact effected by a micro switch.

- \* nominal diameter 25-200
- \* precise adjustment of the setpoint by adjusting screw
- \* hermetic separation of electrical and hydraulic components
- \* protection of functional components from liquid by rubber bellow

Male thread R1" brass/stainless steel



## TECHNICAL DATA

| DN  | Qmax. recom.<br>m <sup>3</sup> /h H <sub>2</sub> O | adjustable range<br>m <sup>3</sup> /h H <sub>2</sub> O | paddle  |
|-----|--|--|---------|
| 32  | 6  | 2.1 - 3.0  | 1       |
| 40  | 9  | 3.0 - 4.2  | 1       |
| 50  | 15   | 1.7 - 2.5  | 1,2     |
| 65  | 24   | 5.1 - 7.0  | 1,2     |
| 80  | 36   | 3.5 - 5.1  | 1,2,3   |
| 100 | 60   | on request   | 1,2,3   |
|     | 60   |  | 1,2,3,4 |
| 150 | 120  | on request   | 1,2,3   |
|     | 120  |  | 1,2,3,4 |
| 200 | 240  | on request   | 1,2,3   |
|     | 240  |  | 1,2,3,4 |

Adjustable range is indicated for horizontally decreasing flow.

|                       |                           |
|-----------------------|---------------------------|
| tolerance             | ±15 % of full scale       |
| media temperature     | max. 110°C                |
| average pressure loss | 0.15 bar at Qmax.         |
| hysteresis            | depending on switch value |
| weight                | 0.35kg                    |

## MATERIALS

|         |  |  |
|---------|--|--|
| housing | brass Ms58                                 | stainless steel                                |
|         | nickel plated                              | 1.4571   |
| paddle  | stainless steel 1.4301 ;<br>1.4571 ; brass | stainless steel<br>1.4301 ; 1.4571 ;<br>1.4305 |
| bellow  | CR   | CR   |
| spring  | stainless steel 1.4310                     | stainless steel 1.4310                         |
| magnet  | oxyd 300                                   | oxyd 300                                       |

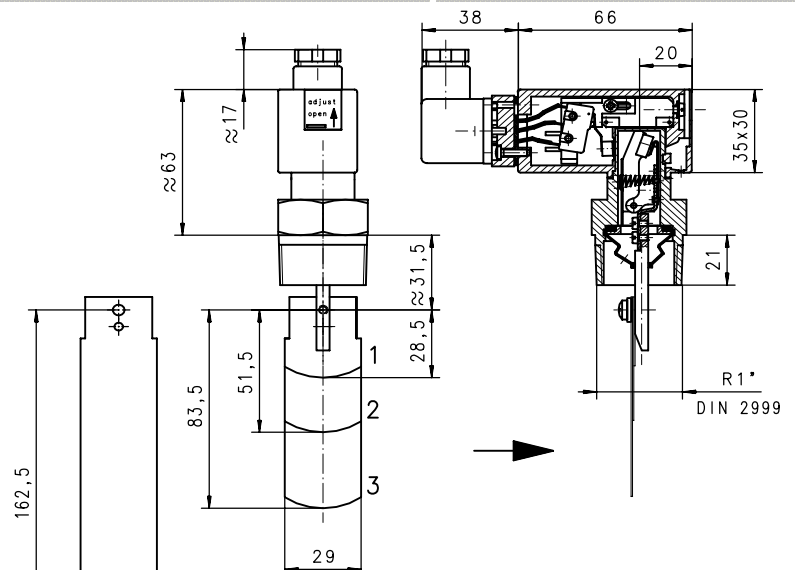

Paddel 1 to adjusted for DN25  
 Paddel 4 may be adjusted to pipe size  
 DN 100 paddle length 92  
 DN 125 paddle length 117  
 DN 150 paddle length 143  
 from DN 175 original paddle leng